

# BUSINESS PARK FOR LEASE

1,500 - 31,000 SF AVAILABLE

SPALDING WOODS 100 - 300  
3850 HOLCOMB BRIDGE ROAD  
NORCROSS, GA 30092





# PROPERTY OVERVIEW



**LOCATION** 3850 Holcomb Bridge Road  
Norcross, GA 30092

**SUBMARKET** Norcross/Peachtree Corners

**ZONING** Office-Institutional (O-I)

**YEAR BUILT** 1986

**PARKING** 4/1,000

**LEASE TYPE** Modified Gross

Excellent Visibility

Monument Signage

Abundant Glass

# AVAILABILITY

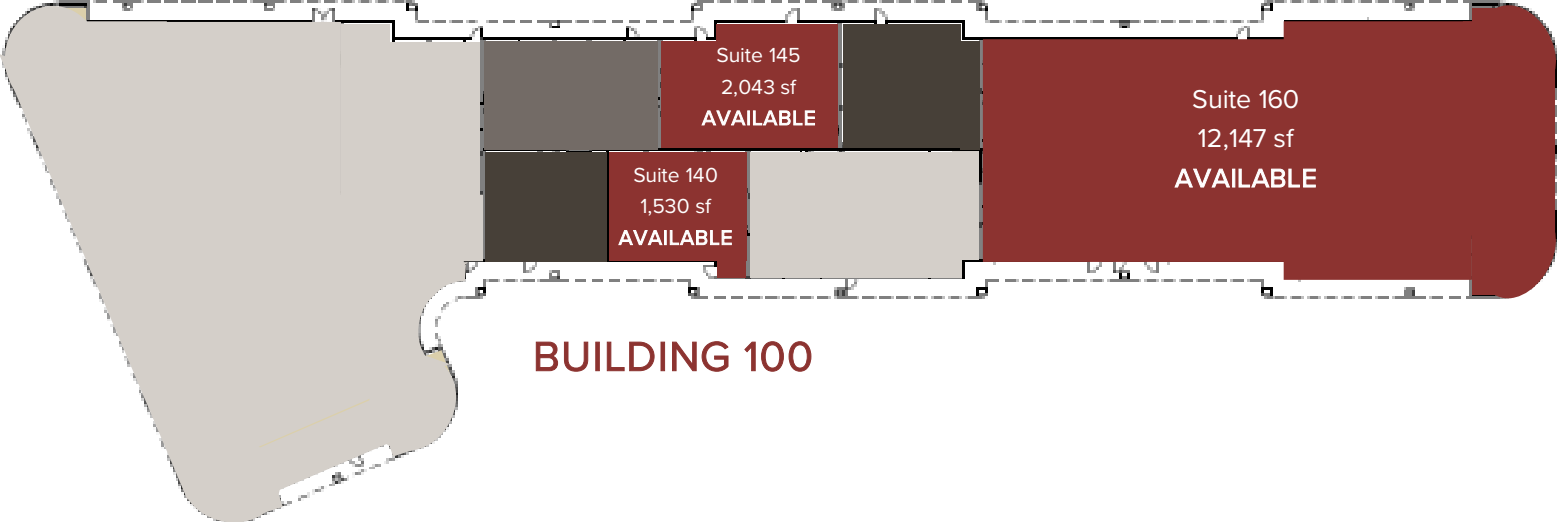

**BUILDING 100**

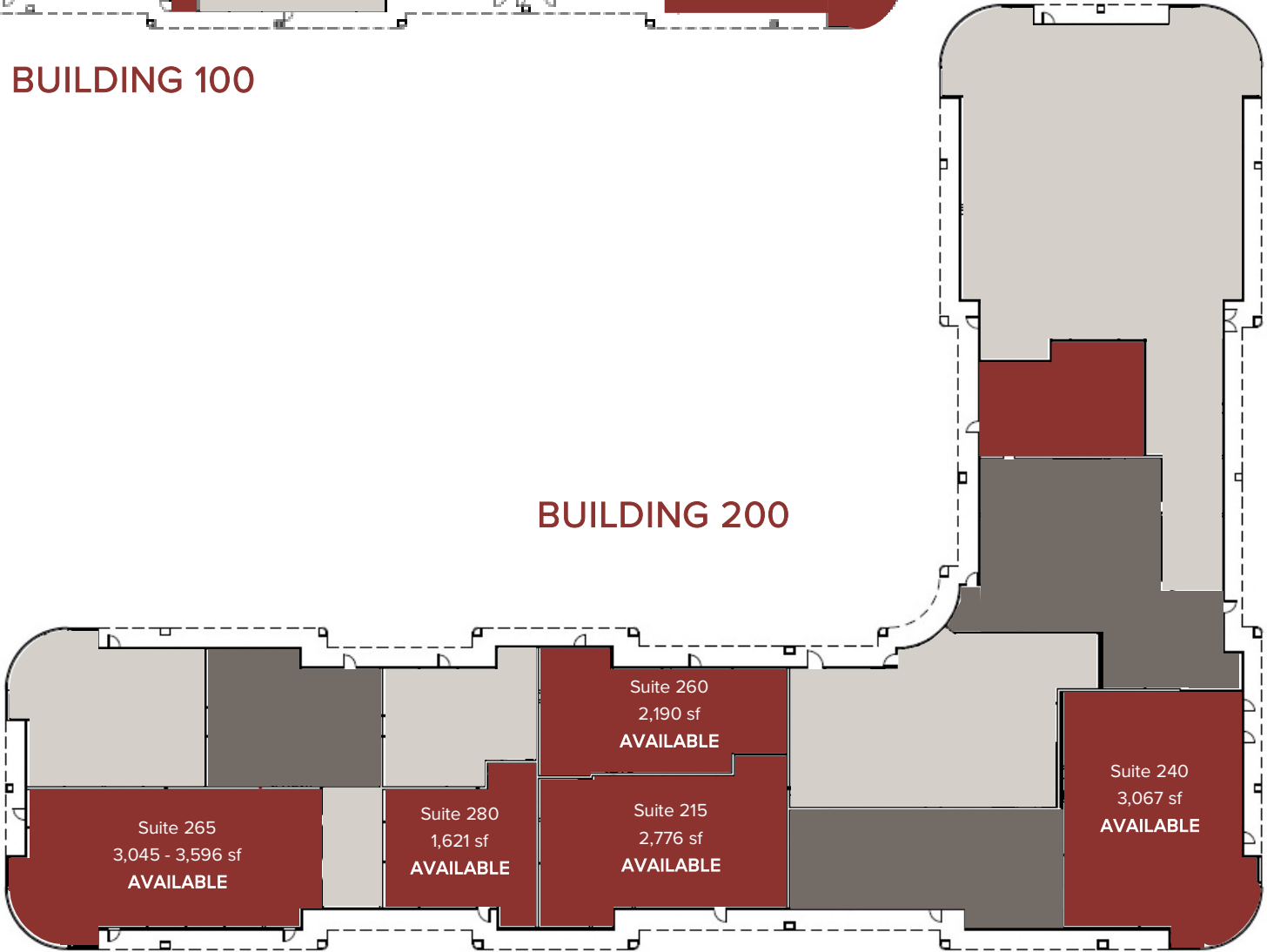

**BUILDING 200**

# AVAILABILITY

